

Instruction Sheet

O-Ring Replacement Kit for the RDO[®] PRO and RDO[®] PRO-X Probe

Part Number 0080810

Kit Contents

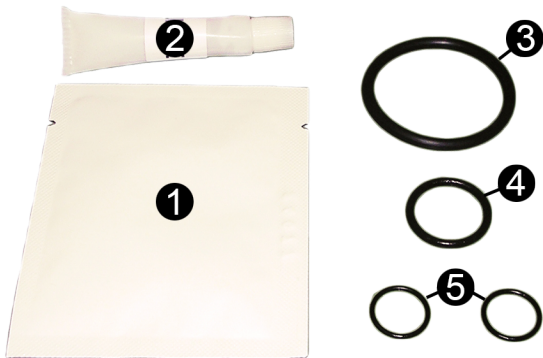

1	Lens cloth
2	Lubricant
3	O-ring for probe body
4	Internal nose cone O-ring
5	Sensor cap O-rings

Replacement Procedure

1. Remove the nose cone from the probe.
2. Use your fingers or a non-metallic tool to remove the worn O-rings from the grooves.
3. Clean all contact surfaces with a swab or lint-free cloth.
4. Using your fingers, apply lubricant evenly to the new O-rings.
5. Place the mid-sized internal nose cone O-ring in the nose cone.



1 | Mid-sized internal nose cone O-ring

6. Place the probe body O-ring on the probe housing.
7. Place the sensor cap O-rings in the grooves on the sensor.
8. Do not transfer lubricant from your fingers to the gold pins on the sensor or the inner lens of the sensor.

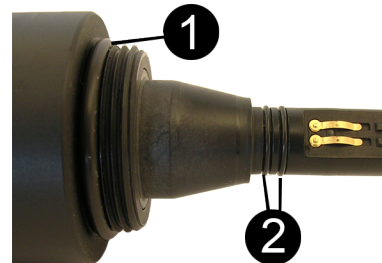

1 | Probe body O-ring

2 | Sensor cap O-rings

9. Clean the lens with the enclosed lens cloth after placing the two O-rings on the sensor.
10. Place the nose cone on the probe.